

**⚠ WARNING**

To avoid unpredictable system behavior that can cause personal injury and property damage:

- Disconnect electrical supply (when necessary) before installation, servicing, or conversion.
- Disconnect air supply and depressurize all air lines connected to this product before installation, servicing, or conversion.
- Operate within the manufacturer's specified pressure, temperature, and other conditions listed in these instructions.
- Medium must be moisture-free if ambient temperature is below freezing.
- Service according to procedures listed in these instructions.
- Installation, service, and conversion of these products must be performed by knowledgeable personnel who understand how pneumatic products are to be applied.
- After installation, servicing, or conversion, air and electrical supplies (when necessary) should be connected and the product tested for proper function and leakage. If audible leakage is present, or the product does not operate properly, do not put into use.
- Warnings and specifications on the product should not be covered by paint, etc. If masking is not possible, contact your local representative for replacement labels.

**⚠ WARNING**

Product rupture can cause serious injury.  
 Do not connect regulator to bottled gas.  
 Do not exceed maximum primary pressure rating.

**Safety Guide**

For more complete information on recommended application guidelines, see the Safety Guide section of Pneumatic Division catalogs or you can download the **Pneumatic Division Safety Guide** at: [www.parker.com/pneumatics](http://www.parker.com/pneumatics)

**⚠ CAUTION**

Polyurethane bowls, sight glass and sight domes on these units may be attacked by certain chemicals. Never use solvents like carbon tetrachloride, trichlorethylene, acetone, or paint thinner to clean any parts. These elements can cause crazing or failure of the plastic parts. The polyurethane resin parts are compatible with most hydrocarbon based synthetic lubricants but, before using, check with the manufacturer of the lubricant or oil for compatibility with polyurethane resin.

**TO CLEAN POLYURETHANE BOWLS USE MILD SOAP AND WATER ONLY!**

**Introduction**

The **B75 Pressure Regulator** is a specialized control valve which reduces the upstream supply pressure level to a specified constant downstream pressure. Pneumatic equipment that is operated at a higher than recommended pressure levels wastes the energy which generates that pressure, creates a potential safety hazard, and wears prematurely. The B75 is a balanced poppet, diaphragm style regulator available in either relieving (standard) or non-relieving (K suffix after part number) design. The **B75 Integral Filter/Regulator** incorporates the R75 regulator with the filtering capabilities of the F75 Filter removing impurities from the airstream two ways - dynamically by centrifugal

force, by which the deflector throws out heavier particles and entrained water; and statically through the filter element itself, which filters out the smaller particles. The B75 Filter/Regulator provides enough filtration for most pneumatic applications, however, in situations where water and/or oil aerosols must also be filtered out a F71 coalescing filter should be installed also. Follow these instructions when installing, operating, or servicing the product.

**Application Limits**

These products are intended for use in general purpose compressed air systems only.

**Maximum Recommended Pressure Drop:**

	kPa	PSIG	bar
Particulate Filter	70	10	0.7

**Operating Pressure Maximum**

	kPa	PSIG	bar
Polycarbonate Bowl	1034	150	10.0
Metal Bowl	2068	300	21.0
Metal Bowl with Sight Gauge	1724	250	17.0
Metal Bowl with Piston Drain	1207	175	12.0

**Operating Temperature Range**

Polycarbonate Bowl	4°C to 49°C (40°F to 120°F)
Metal Bowl	4°C to 82°C (40°F to 180°F)
Metal Bowl with Sight Gauge	4°C to 66°C (40°F to 150°F)
Metal Bowl with Piston Drain	4°C to 66°C (40°F to 150°F)

**Symbols**

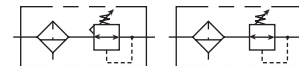

**Filter / Regulator**

**⚠ WARNING**

**FAILURE OR IMPROPER SELECTION OR IMPROPER USE OF THE PRODUCTS AND/OR SYSTEMS DESCRIBED HEREIN OR RELATED ITEMS CAN CAUSE DEATH, PERSONAL INJURY AND PROPERTY DAMAGE.**

This document and other information from The Company, its subsidiaries and authorized distributors provide product and/or system options for further investigation by users having technical expertise. It is important that you analyze all aspects of your application, including consequences of any failure and review the information concerning the product or systems in the current product catalog. Due to the variety of operating conditions and applications for these products or systems, the user, through its own analysis and testing, is solely responsible for making the final selection of the products and systems and assuring that all performance, safety and warning requirements of the application are met.

The products described herein, including without limitation, product features, specifications, designs, availability and pricing, are subject to change by The Company and its subsidiaries at any time without notice.

**EXTRA COPIES OF THESE INSTRUCTIONS ARE AVAILABLE FOR INCLUSION IN EQUIPMENT / MAINTENANCE MANUALS THAT UTILIZE THESE PRODUCTS. CONTACT YOUR LOCAL REPRESENTATIVE.**

## Installation

All QUBE components are individually tapped (NPT or BSPP) to allow direct mounting to piping. Also, each FRL component comes equipped with the necessary screws and O-rings to enable connection to other QUBE components of the same series without the need for pipe nipples or special adaptors. Before installing, blow out pipe line to remove scale and other foreign matter. This unit has DRYSEAL pipe threads; use pipe compound or tape sparingly to male threads only. Install units in pipeline so that flow is with the arrows as indicated on the top of the body. Install as near as possible to equipment serviced.

## Reduced Pressure Adjustment

To adjust reduced pressure settings, pull knob out and turn knob clockwise to increase pressure setting and counter-clockwise to lower setting. Push knob in to lock adjustment. With relieving-type regulators, the reduced pressure follows adjustment of the screw. With non-relieving

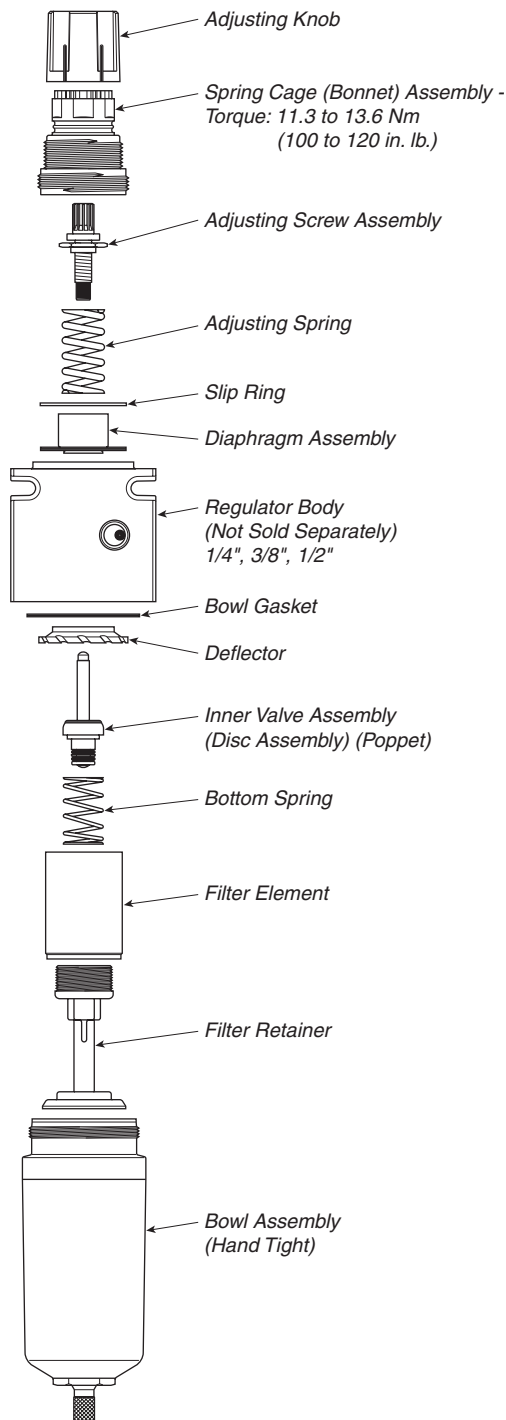

regulators, adjustment for lower reduced pressure will not be obtained until the reduced pressure system is "bled-off" or until air flow starts.

## Maintenance – Cleaning

Note: To clean, it is not necessary to remove regulator from line. Refer to drawing as guide in reassembly. If the air supply is kept clean, the regulator should provide long periods of uninterrupted service. Erratic regulator operation or loss of regulation is most always due to dirt in the disc area. To clean, shut off air line pressure and disassemble the regulator. Refer to drawing as a guide to disassembly and subsequent reassembly. Clean parts with household soap and blow out body with compressed air. When reassembling make sure the disc is firmly in place and that the disc stem fits into the center hole of the diaphragm assembly. Tighten bowl assembly hand tight.

## Service Kits / Parts Available

Description	R75, 1/4", 3/8", & 1/2"
Adjusting Knob (In Kit CKR75)	R35-0545P
Spring Cage (In Kit CKR75)	R75-0151P
Adjusting Screw Assembly (In Kit CKR75)	SAR55-0532
Adjusting Spring "A" Range (0 – 25 PSI) "B" Range (0 – 60 PSI) "C" Range (0 – 125 PSI)	SPR-53 SPR-54 SPR-55
Slip Ring (In Repair Kit)	R55-0081
Diaphragm Assembly Relieving (In Kit RKR75) Non-Relieving (In Kit RKR75K)	SAR75-0201 SAR75-0202
Bowl Gasket (In Bowl Assembly Kit)	GSK-F55-1011
Deflector, Filter Retainer	RKF55
Inner Valve Assembly (In Kit RKR75)	SAR75-0371
Bottom Spring	SPR 391-1
Filter Element "G" - 5 µ "J" - 40 µ	EK55G EK55J
Bowl Assembly "B" - Polyurethane w Polyethylene Bowl Guard, 150 PSI Maximum Pressure "D" - Zinc Bowl, 300 PSI Max. Pressure "W" - Zinc Bowl w/Wraparound Sight Glass, 250 PSI Maximum Pressure	BKF55B BKF55D BKF55W
Repair Kit Relieving Non-Relieving	RKR75 RKR75K
Spring Cage Kit Tamperproof (Not Shown)	CKR75 CKR75T

## Accessories

Gauge 0 to 60 PSI (0 to 4 bar) 0 to 160 PSI (0 to 11 bar)	K4515N18060 K4515N18160
Panel Mount Nut * Acetal Plastic Aluminum	R05X51 R05X51-A
Wall Mount Bracket	SAR55Y57
Internal Automatic Drain Plastic ("R" Option, 175 PSI Max. Pressure) Brass Brass (W Bowl Only)	SA602MD SA605MD SAF105MD

\* Requires 1-1/4" hole (1-3/16-18 UNEF-2B)